

Nanodyne Replacement Illuminator for Leica DMIRE2 / DMIRB Microscope Installation Instructions - Included Items

PN 12212 Leica DMIRE2 Illuminator Assy

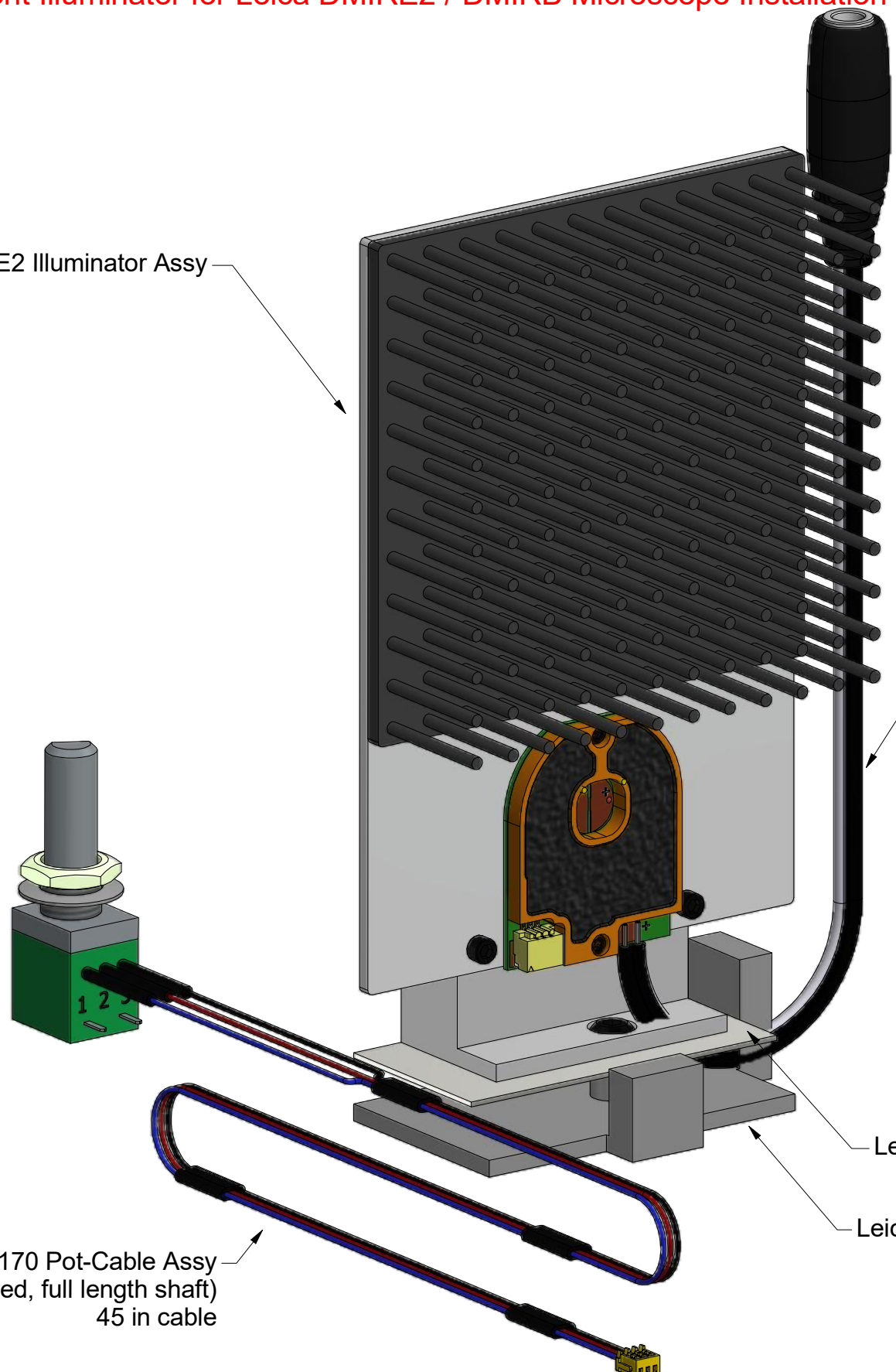

PN 11531 Power Cable Jack to Wires (6 in cable)

Leica DMIRE2 Microscope OEM bracket

Leica DMIRE2 Microscope frame

PN 11170 Pot-Cable Assy (detabbed, full length shaft) 45 in cable

Also Included but not shown:
 PN 10337 Hex Key 2mm Short Arm (for M3 BHCS)
 PN 10457 Hex Key 2.5mm Short Arm (for M3 SHCS)

The illuminator may be powered by plugging the cable into the power supply provided, or into a suitable USB port on a computer or other device.



PN 12434 Power Supply US 15V36W Barrel Plug 2.5mm x 5.5mm x 9.5mm and PN 10734 Power Cable 1.35mm ID/3.5mm OD x USB A 6 ft.



Tape to secure wires.

Power supplies are subject to substitution without notice due to availability issues and changes in regulations.

Han-Seung Yang	10/30/2023
PN 12213 Leica DMIRE2 System Installation Instructions	REV 1
SHEET 1 OF 5	



Nanodyne Replacement Illuminator for Leica DMIRE2 / DMIRB Microscope Installation Instructions - Step 1. Remove OEM Lamp Cover and Bulb.

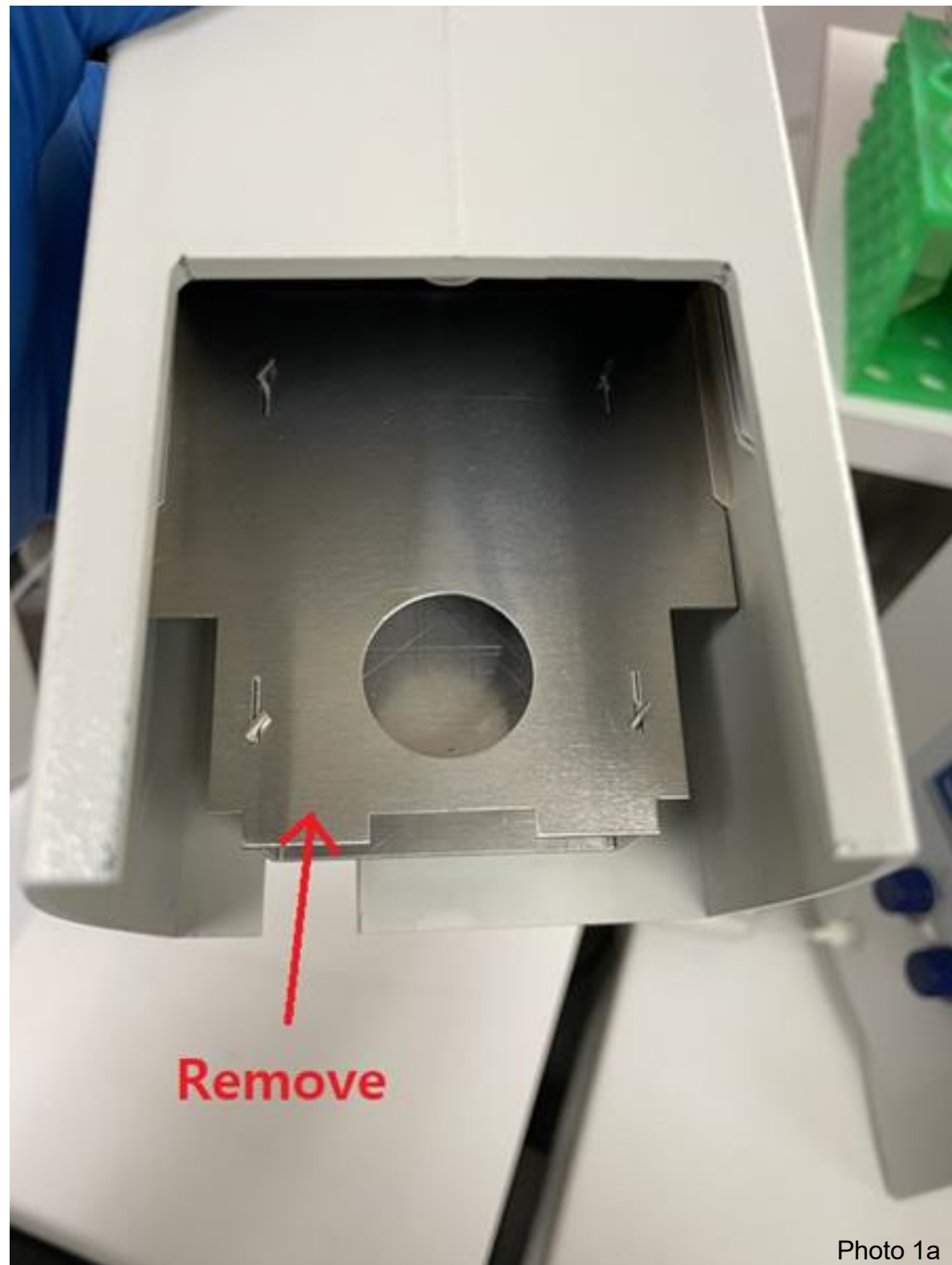

Photo 1a

Remove the thin metal lamp cover.



Photo 1b

Unscrew and remove the original light bulb. Do not remove the thin metal bracket.

Han-Seung Yang 10/30/2023

PN 12213 Leica DMIRE2 System Installation Instructions REV 1

SHEET 2 OF 5



Nanodyne Replacement Illuminator for Leica DMIRE2 / DMIRB Microscope Installation Instructions - Step 2. Install Nanodyne Illuminator Assembly.

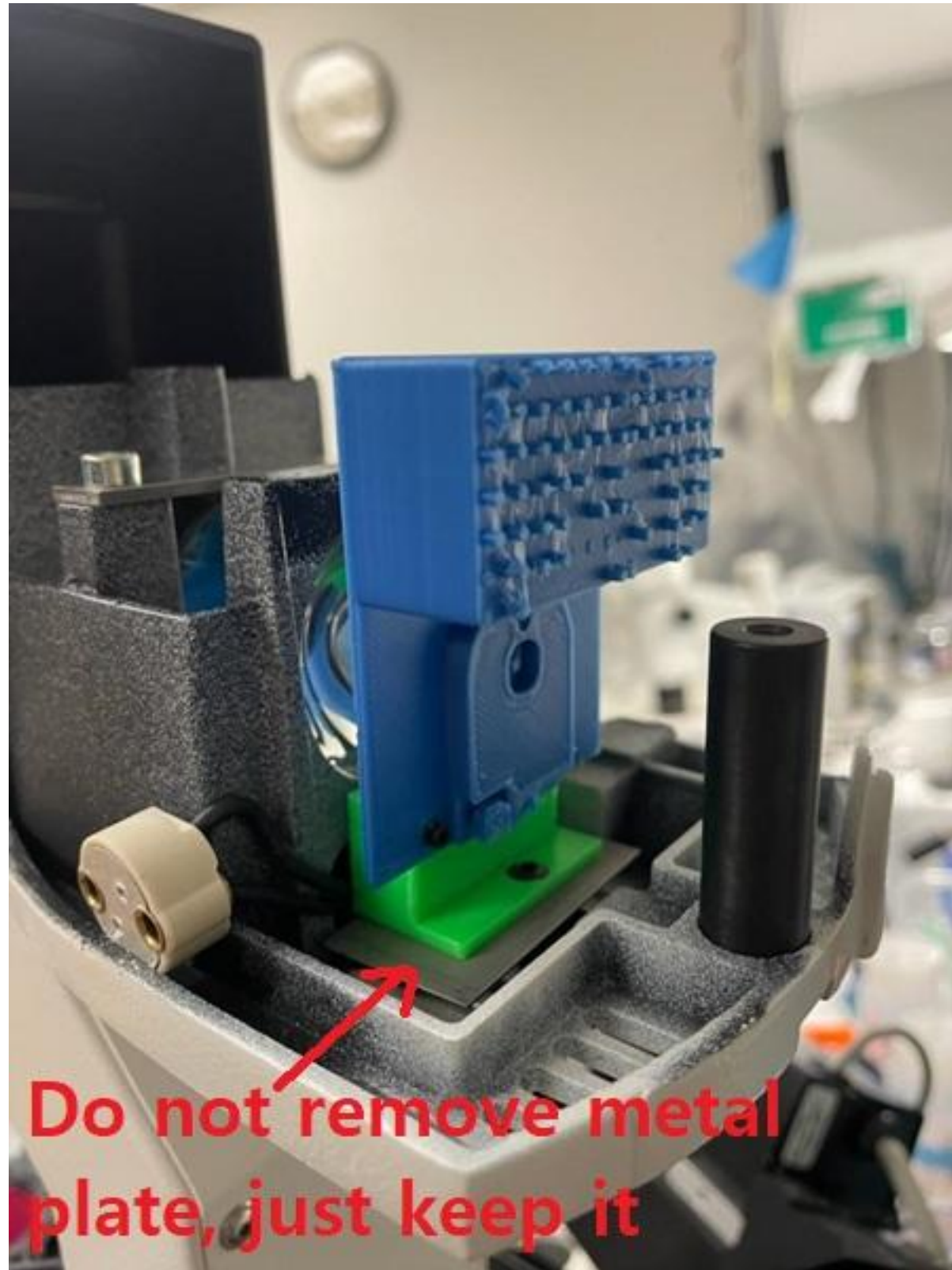

Photo 2a

Place Nanodyne illuminator assembly.

****Note:** Please note that the illuminator assembly shown in the photo is 3D printed prototype for the initial verification purpose.

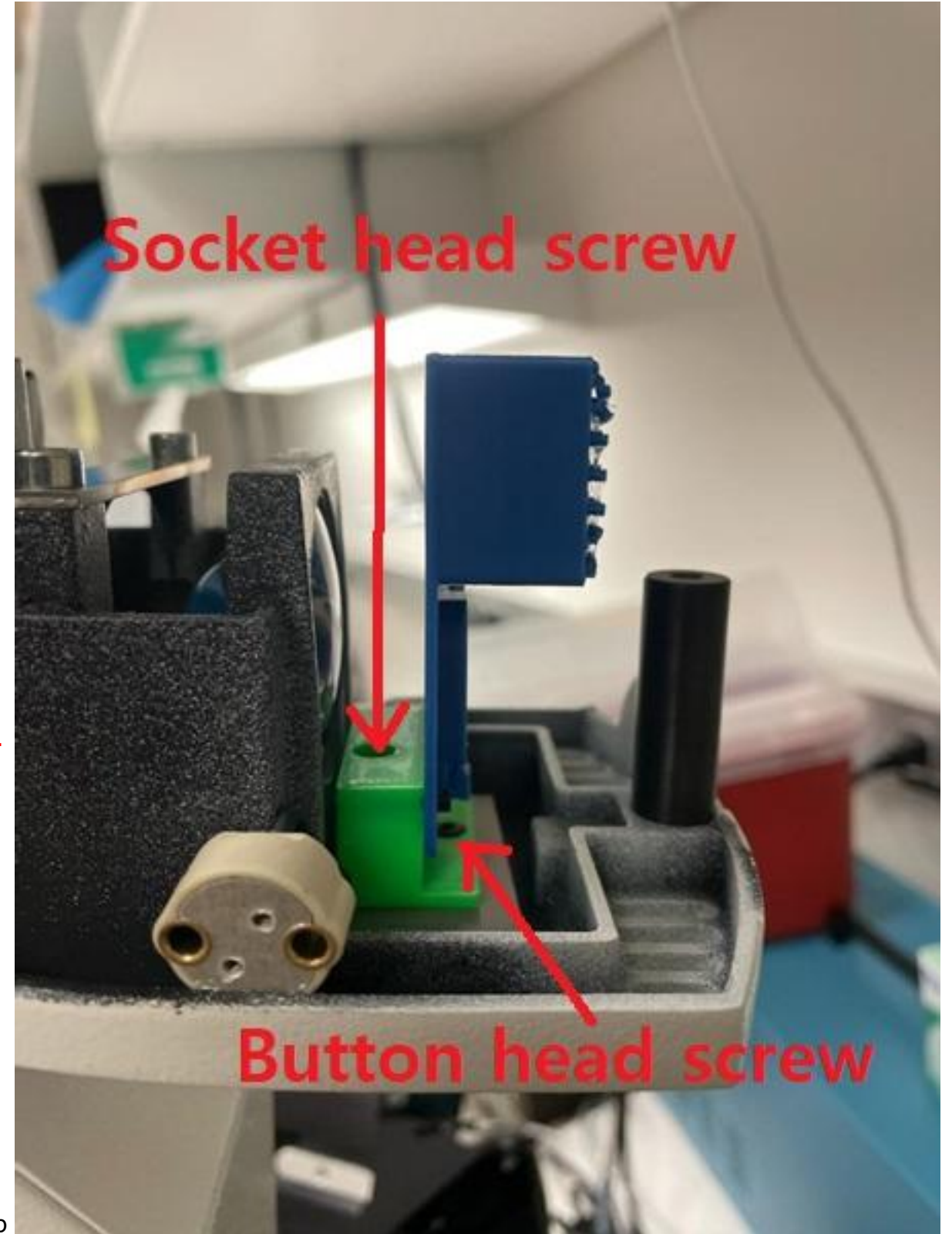
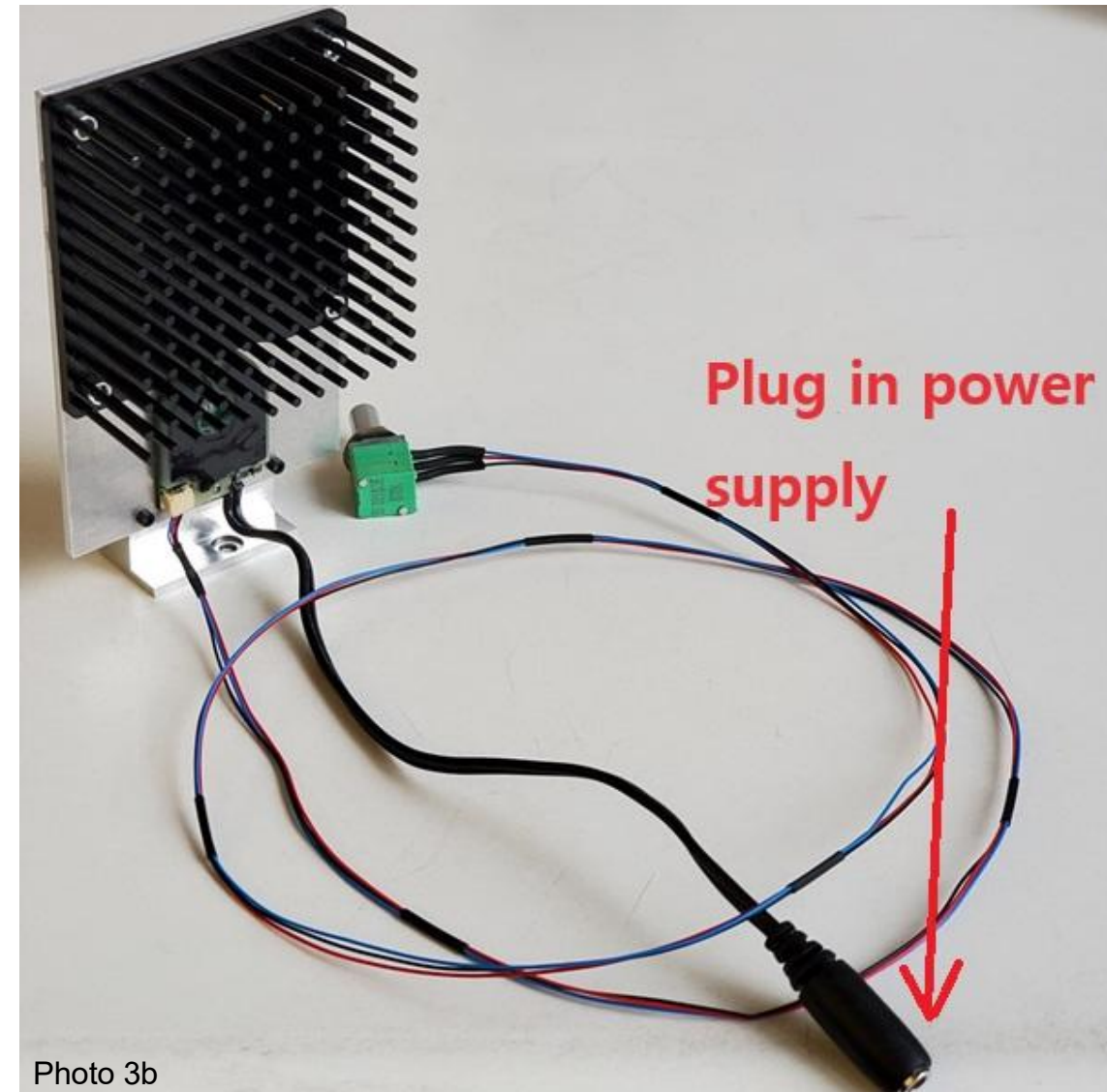
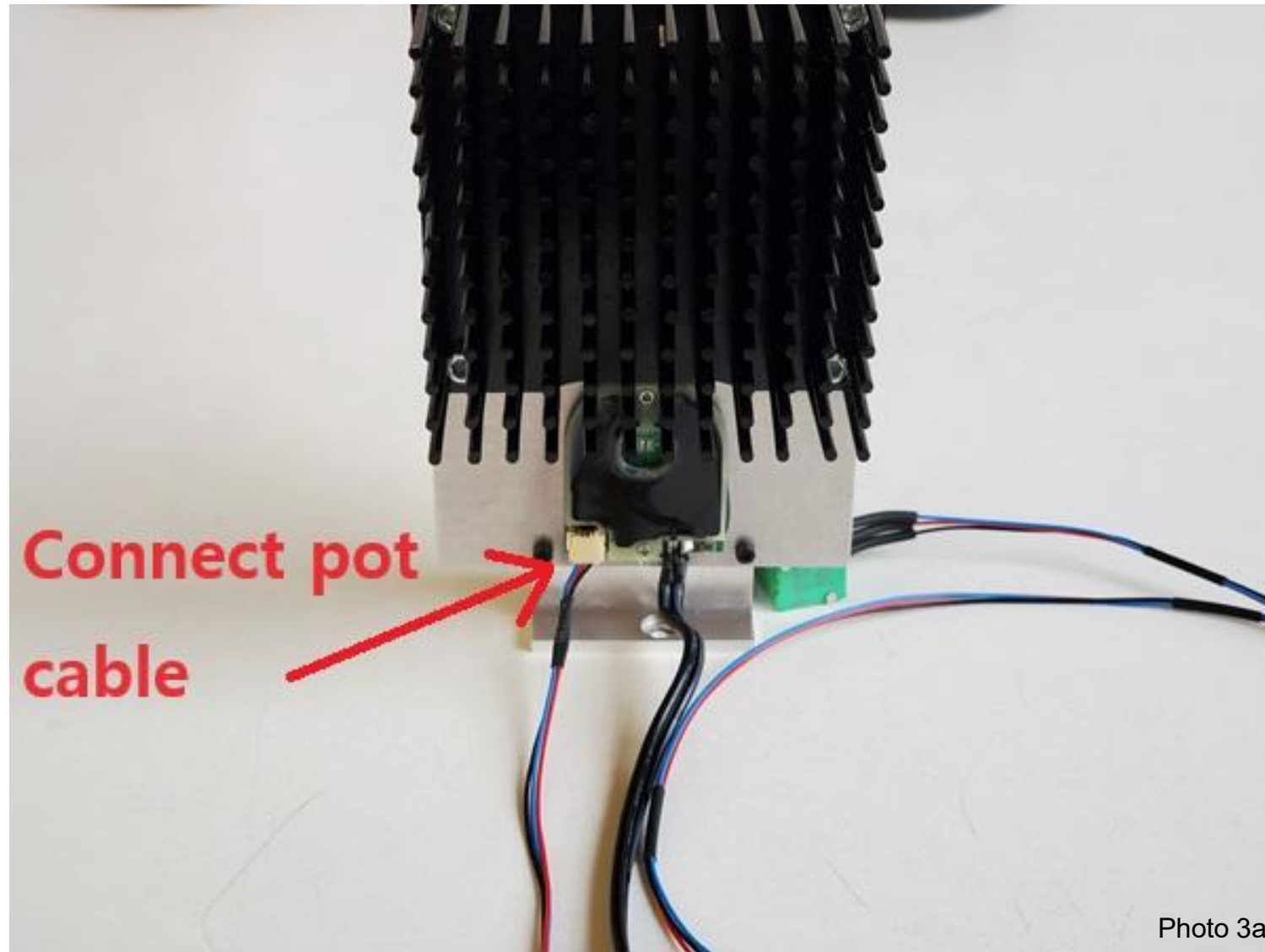

Photo 2b

Tighten socket and button head screws provided.

Han-Seung Yang	10/30/2023
PN 12213 Leica DMIRE2 System Installation Instructions	REV 1
SHEET 3 OF 5	

Nanodyne Replacement Illuminator for Leica DMIRE2 / DMIRB Microscope Installation Instructions - Step 3. Install and Route Pot Cable, Plug in Power Supply.



Connect pot cable assembly and route the cable. Nanodyne potentiometer replaces the original one.

Detailed pot cable connection procedure is shown on the next page (sheet 5).

Plug the power supply into an AC outlet and connect the power cord. Re-install all of the covers. The illuminator is now ready to use.

Han-Seung Yang	10/30/2023
PN 12213 Leica DMIRE2 System Installation Instructions	REV 1
SHEET 4 OF 5	

Nanodyne Replacement Illuminator for Leica DMIRE2 / DMIRB Microscope Installation Instructions - Step 4. Pot Cable Connection Detail.

Connect the plug at the end of the Pot Cable Assembly to the mating socket of the illuminator, as shown in the pictures on this page. NOTE THAT THE PLUG IS KEYED TO ONLY GO INTO THE SOCKET ONE WAY, AS SHOWN.

Partially insert the plug into the mating socket of the illuminator by holding the wire next to the plug with your finger (photo 2).

Use your fingernails, if you have them, or tools like a tiny screwdriver or tweezers pushing on the side of the plug to fully insert it (photo 3).

The socket cannot be fully engaged by pushing on the wires, as the wires would just collapse.

To disconnect it if needed, pull the wire straight out by firmly gripping the black heat shrink tubing.

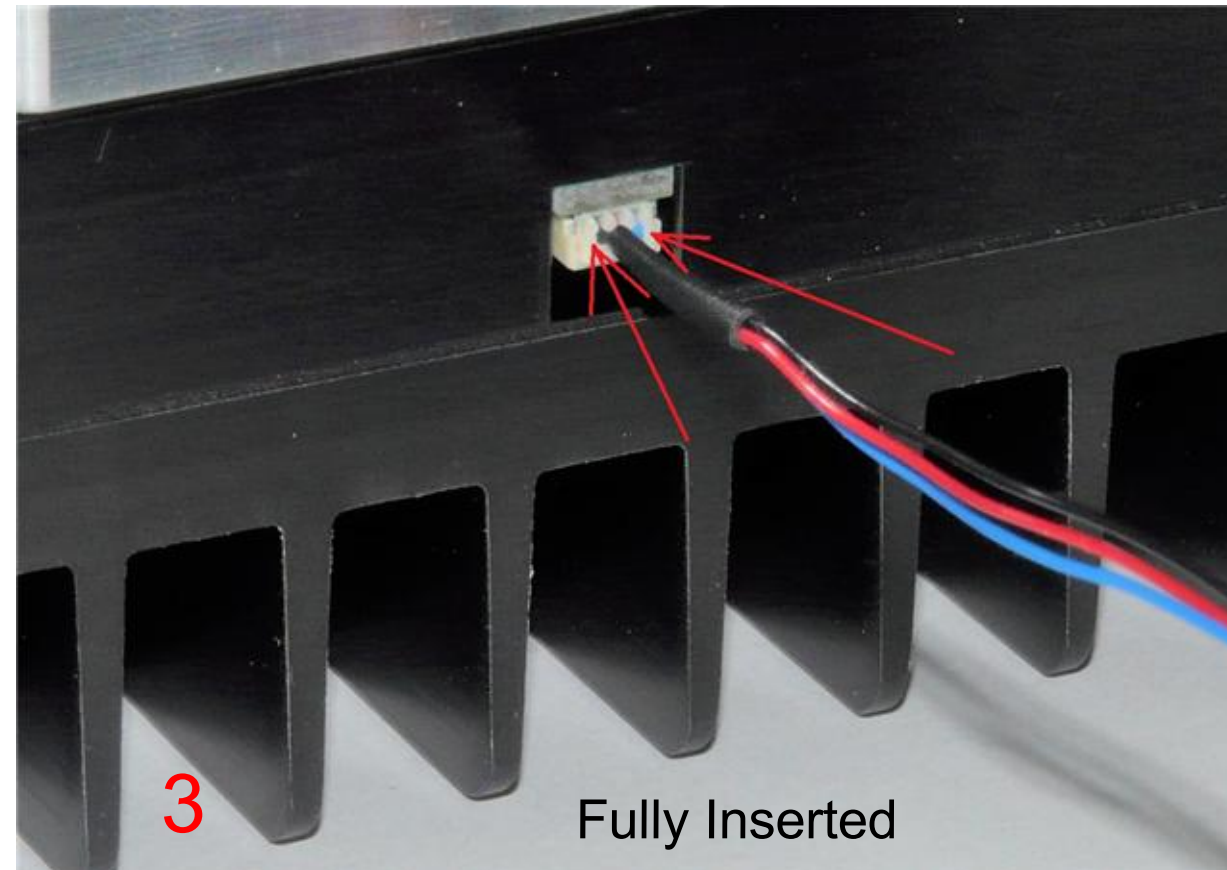
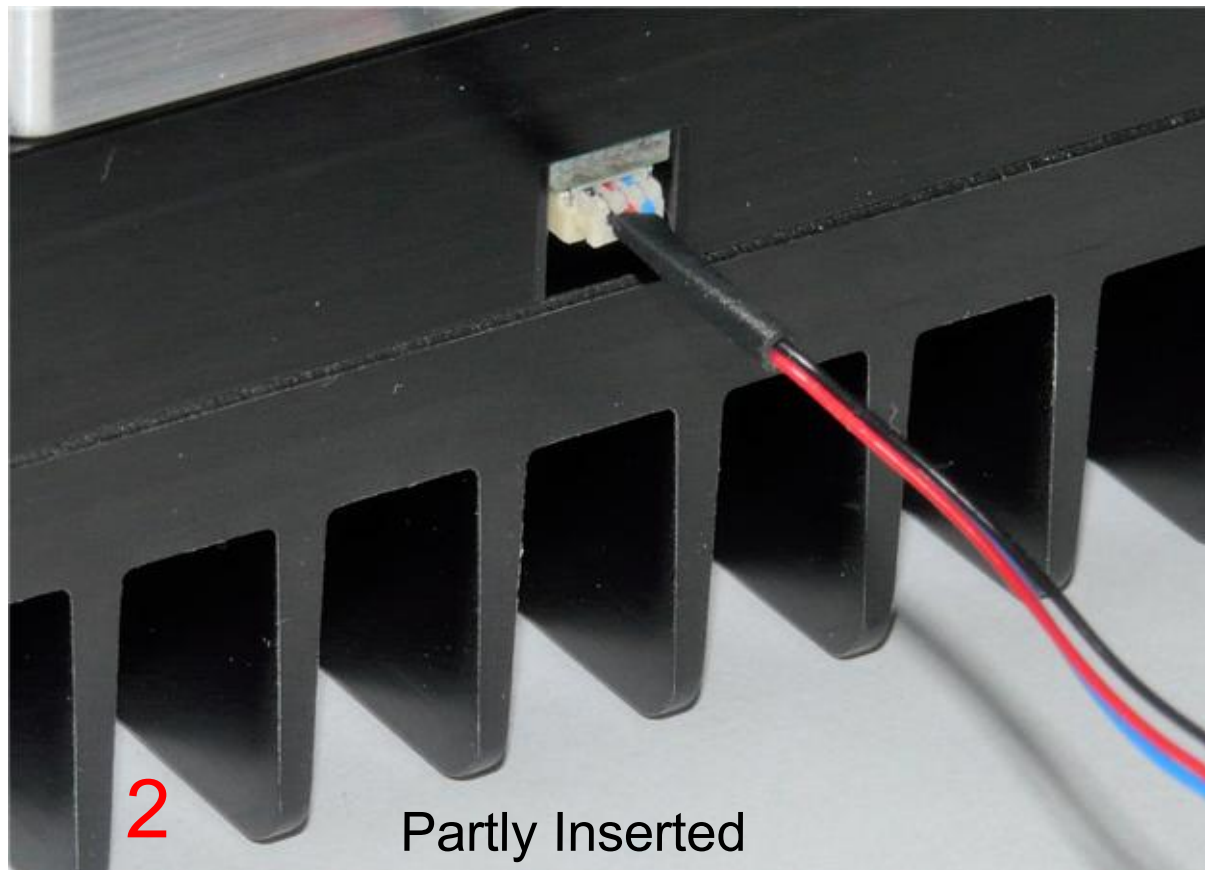
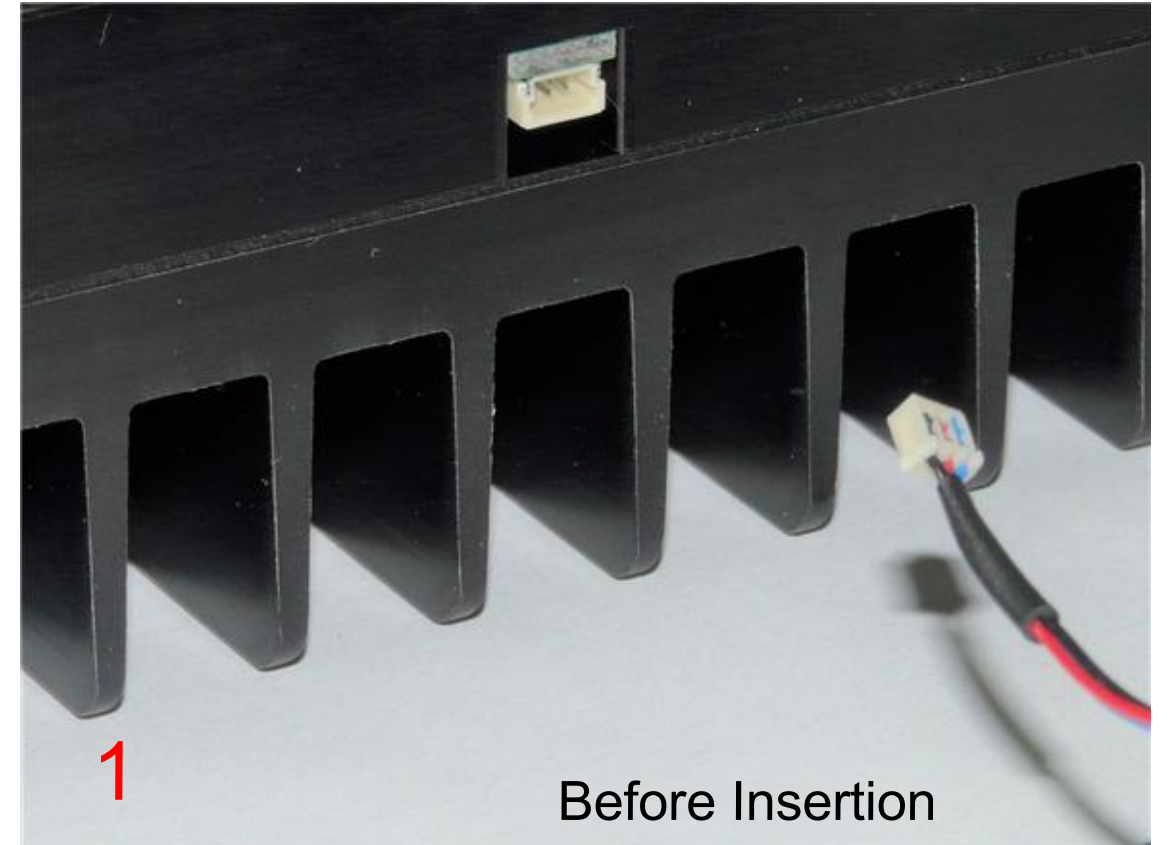

Han-Seung Yang	10/30/2023
PN 12213 Leica DMIRE2 System Installation Instructions	REV 1
SHEET 5 OF 5	